

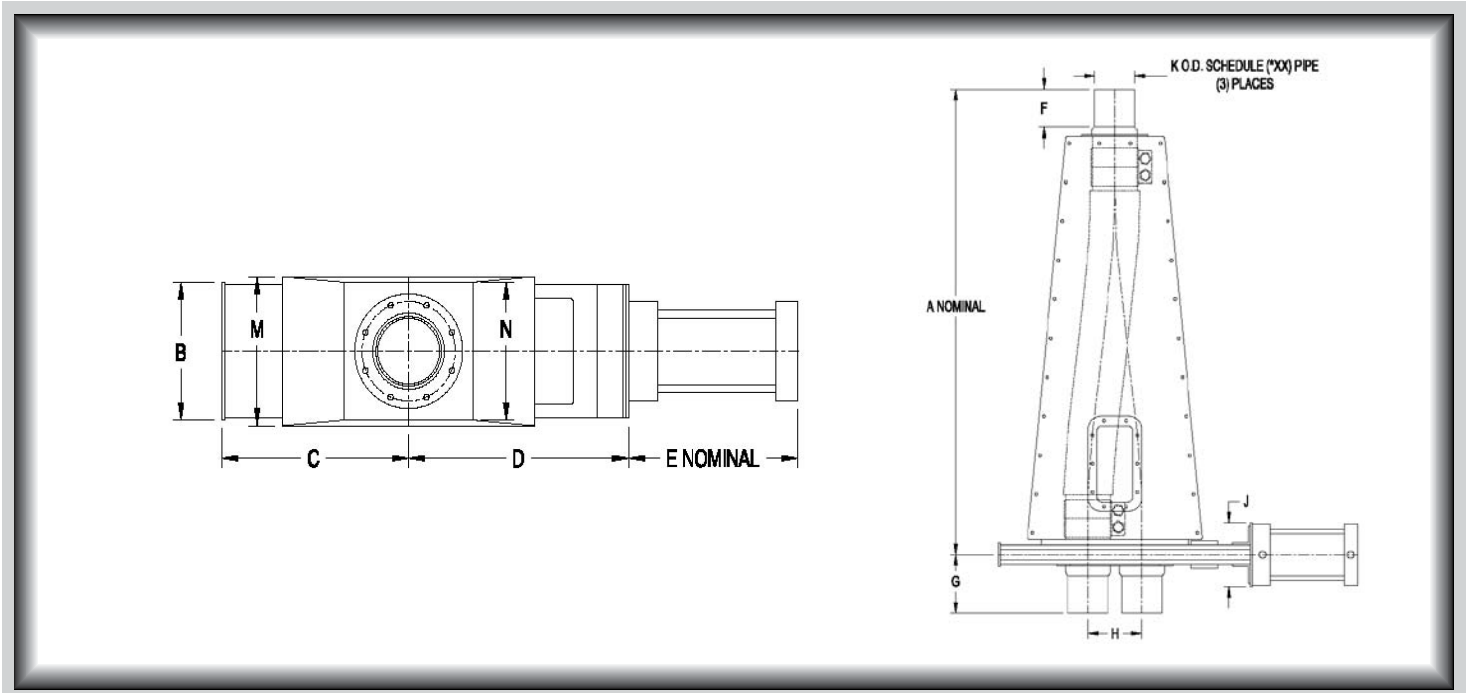

VORTEX® 2-WAY FLEX TUBE DIVERTER™ DIMENSIONAL INFORMATION



MODEL	TUBE SIZE	A	B	C	D	E	F	G	H	J	K	M	N	WT (kg)
T2-2(XX)Y	51	775	127	149	197	184	76	108	64	121	51	159	127	36
T2.5-2(XX)Y	64	895	165	197	251	203	105	133	89	133	64	203	168	41
T3-2(XX)Y	76	867	165	197	251	203	73	105	89	159	76	203	168	43
T4-2(XX)Y	102	1108	191	270	340	248	79	108	127	140	102	216	181	57
T5-2(XX)Y	127	1213	229	330	391	298	95	130	152	171	127	248	232	66
T6-2(XX)Y	152	1527	264	378	441	324	102	130	178	171	152	298	257	98
T8-2(XX)Y	203	1664	318	546	584	406	98	235	254	194	203	333	333	120

MODEL	PIPE SIZE	A	B	C	D	E	F	G	H	J	K	M	N	WT (kg)
T2-2(XX)Y-P*	51	895	165	197	251	203	76	133	89	159	60	203	168	45
T2.5-2(XX)Y-P*	64	895	165	197	251	203	76	133	89	159	73	203	168	45
T3-2(XX)Y-P*	76	1159	191	270	340	235	102	159	127	140	89	216	181	59
T4-2(XX)Y-P*	102	1245	229	330	391	298	102	159	152	171	114	248	232	68
T5-2(XX)Y-P*	127	1553	264	378	441	324	102	156	178	171	141	298	257	100
T6-2(XX)Y-P*	152	1565	264	378	441	324	102	187	194	171	168	298	257	100
T8-2(XX)Y-P*	203	1759	318	546	584	406	152	241	254	194	219	333	333	123

All dimensions are in mm, Information subject to change without notice.

(XX) Material of construction, aluminum (AL), carbon steel (CS), or stainless steel (SS).

*Select pipe schedule 10 or 40, note flex tube is O.D. hose.